

AGW/AGF Thermowells

**Welded thermowells AGWR,
mounted on flanges ISO/ANSI:AGW**

**Bored thermowells AGFR,
mounted on flanges ISO/ANSI:AGF**

AGW and AGF thermowells are recommended for protecting the stems of BAUMER thermometers from pressures of solid particles in suspension or from aggressive fluids. Another advantage of thermowells is the possibility of removing the indicator without any risk of affecting the tightness of the enclosure and without stopping the process.



Characteristics

AGWR/AGW

F	H*/flat indicative	Di x Dg
G 1/2 - 1/2 NPT	27	8 x 10 - 10 x 12 - 12 x 14
G3/4 - 3/4 NPT	30 ... 36	8 x 10 - 10 x 12 - 12 x 14 16 x 18
G1 - 1 NPT	36 ... 41	8 x 10 - 10 x 12 12 x 14 - 16 x 18

AGFR/AGF

F	H*/flat indicative	Di	Dg or Dg2 max.
G 1/2	27	7 .. 13	17.5
1/2 NPT - 1/2 BSP-Tr	27	7 .. 13	17.5
G 3/4	27	7 .. 15	23
3/4 NPT - 3/4 BSP -Tr	27	7 .. 15	22
G 1	36	7 .. 15	29
1 NPT - 1 BSP-Tr	27	7 .. 15	28

Min. thickness of the wall 2mm. Example: Di 8 → Dg min. 12

Material	Stainless steel 1.4404
Standard immersion lengths	Pg = 150, 200, 250, 300 and 400 (for AGW other lengths on request. Max 1000mm)
Max. temperature⁽¹⁾	600°C
Max. (static) pressure⁽¹⁾	According to the thermowell dimensions and/or PN of the flange
Min. thickness of thermowell	AGW/AGWR = 1 mm AGR/AGFR = 2 mm ⁽¹⁾
AGW/AGF construction (standard)	Thermowell screwed/welded on the flange

Options (contact us)

- Cone-shaped thermowell for AGFR/AGF, state Dg1 and Dg2
- Full penetration welding
- Forged material
- Sweating of weldings
- Radiography of weldings
- Internal hydraulic test
- External hydraulic test

⁽¹⁾ Admissible values in service depend on:
 - process fluid
 - service temperatures and pressures
 - flow
 - thermowell type and dimensions

Dimensions (mm) – Types of mounting

AGWR

Without extension

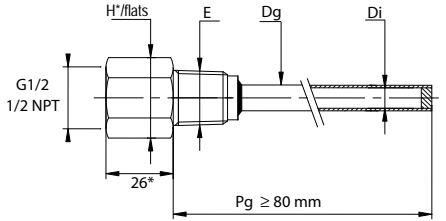

Nota: if $Pg < 80\text{mm}$, take AGFR

* Indicative

AGWR

With extension

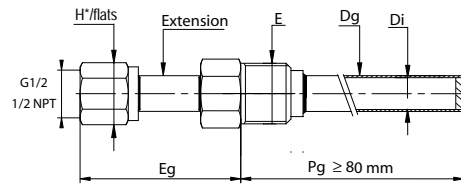

* Indicative

Standard extension: 100 mm

AGW

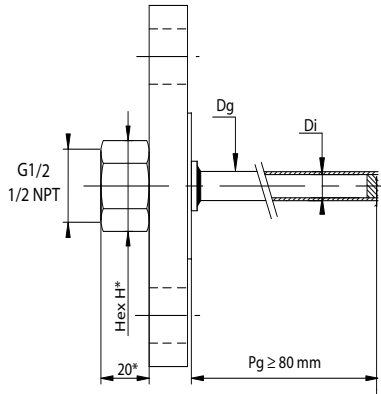

* Indicative

Nota: A 10mm gap is necessary between the the extremity of the bulb and the bottom of the thermowell.

Nota: if $Pg < 80\text{mm}$, take AGF

AGW

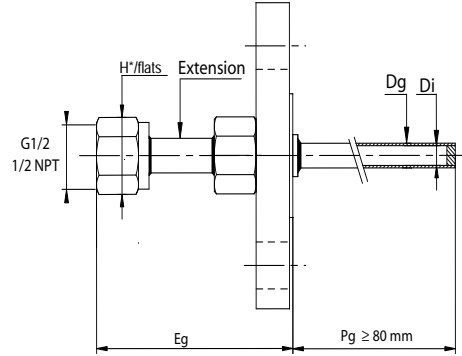

* Indicative

AGFR

Without extension

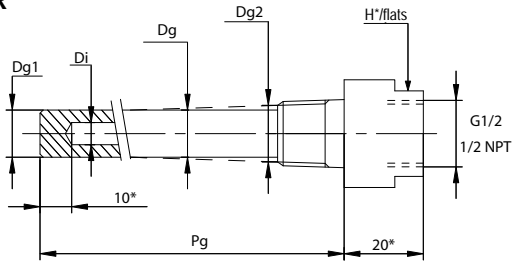

* Indicative

Standard immersion lengths
Pg 150 - 200 - 250 - 300 - 400mm (max.)

AGFR

With extension

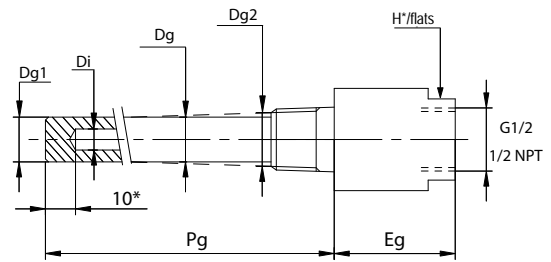

* Indicative

Standard extension: 100 mm
Standard material: stainless steel

AGF

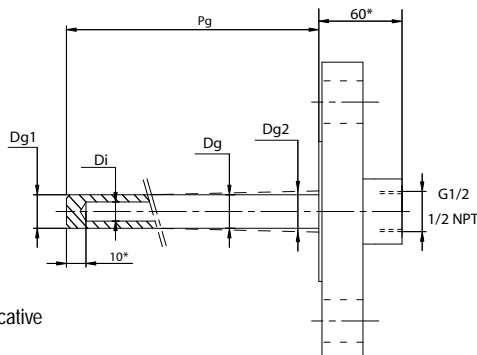

* Indicative

Nota: A 20mm gap is necessary between the the extremity of the bulb and the bottom of the thermowell.

AGF

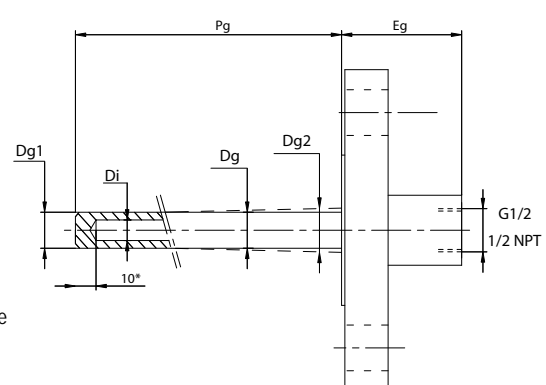

* Indicative

Ordering details – AGW/AGF

AGxxxxxxxxxxxx	
Model	1' ... 3' digit
Welded thermowell with flange	AGW
Bored thermowell with flange	AGF
Type of mounting	4' digit
With flat face flange (standard machining)	A
With raised face flange (all types B, B1, B2)	B
With male tongue flange	C
With female groove flange	D
With male spigot flange	E
With female spigot flange	F
With wide male tongue flange	H
With narrow male tongue flange	I
With wide female groove flange	K
With narrow female groove flange	L
With wide male spigot flange	M
With narrow male spigot flange	N
With wide female spigot flange	O
With narrow female spigot flange	P
With flange for ring joint (RJT)	Q
With other face flanges	x
Extension	5' digit
Without	0
With extension 100mm	1
Other	x
Material	6' digit
Stainless steel 1.4404	2
SS DUPLEX 1.4462	P
A350 LF2	R
Other	x
} AGF only	
Mounting flange PROCESS	7' digit
PN flange ISO	
PN 10	C
PN 16	D
PN 20	E
PN 25	F
PN 40	G
PN 50	H
PN 100	J
PN 150	K
PN 250	L
PN 420	M
ANSI	
Class 150	1
Class 300	2
Class 600	3
Class 900	4
Class 1500	5
Class 2500	6
DN	8' digit
For flange ISO	
DN 15	C
DN 20	D
DN 25	E
DN 32	F
DN 40	G
DN 50	H
DN 65	J
DN 80	K
DN 100	L
Other	x
For flange ANSI	
1/2"	2
3/4"	3
1"	4
1 1/4"	5
1 1/2"	6
2"	7
2 1/2"	8
3"	9
4"	V
Other	x
Fitting female thread (measuring instrument)	9' digit
G 1/2"	L
1/2 NPT	N
Other	x

Thermowells internal diameter Di for AGW		10' digit
8 mm	Di x Dg (8 x 10)	2
10 mm	Di x Dg (10 x 12)	4
12 mm	Di x Dg (12 x 14)	6
16 mm	Di x Dg (16 x 18)	9
Other		x

Thermowells external diameter Dg for AGW		11' digit
10 mm	Di x Dg (8 x 10)	D
12 mm	Di x Dg (10 x 12)	F
14 mm	Di x Dg (12 x 14)	H
16 mm	Di x Dg (16 x 18)	M
Other		x

Plunger length Pg for AGW		12' ...14' digit
100 mm		100
150 mm		150
200 mm		200
250 mm		250
300 mm		300
350 mm		350
400 mm		400
450 mm		450
500 mm		500
550mm		550
600 mm		600
650 mm		650
700 mm		700
750 mm		750
800 mm		800
900 mm		900
Other (1000mm max.)		xxx

OR

Thermowells internal diameter Di for AGF		10' digit
7 mm		1
8 mm		2
9 mm		3
10 mm		4
11 mm		5
12 mm		6
13 mm		7
14 mm		8
16 mm		9
Other		x

Thermowells external diameter Dg for AGF		11' digit
8 mm		A
9 mm		C
10 mm		D
11 mm		E
12 mm		F
13 mm		G
14 mm		H
15 mm		J
16 mm		K
17.5 mm		L
18 mm		M
19 mm		N
20 mm		P
21 mm		Q
22 mm		R
23 mm		T
24 mm		U
25 mm		V
26 mm		W
27 mm		Y
28 mm		1
29 mm		2
Other or cone-shaped ⁽¹⁾		x

Plunger length Pg for AGF		12' ...14' digit
100 mm		100
150 mm		150
200 mm		200
250 mm		250
300 mm		300
350 mm		350
400 mm		400
Other		xxx

⁽¹⁾ State the Dg1 and Dg2 diameters on order

EN/2011-09-06 This data sheet may only be reproduced in full